

DIGITAL MIG WELDING TORCHES

DM24 DIGITAL MIG TORCH



DM24 MIG TORCH

Suregrip™ Series

250A AIR COOLED MIG WELDING TORCH

Rating: 250A CO₂ 220A mixed gas EN60974-7 @ 60% duty cycle. 0.8 to 1.2mm wires

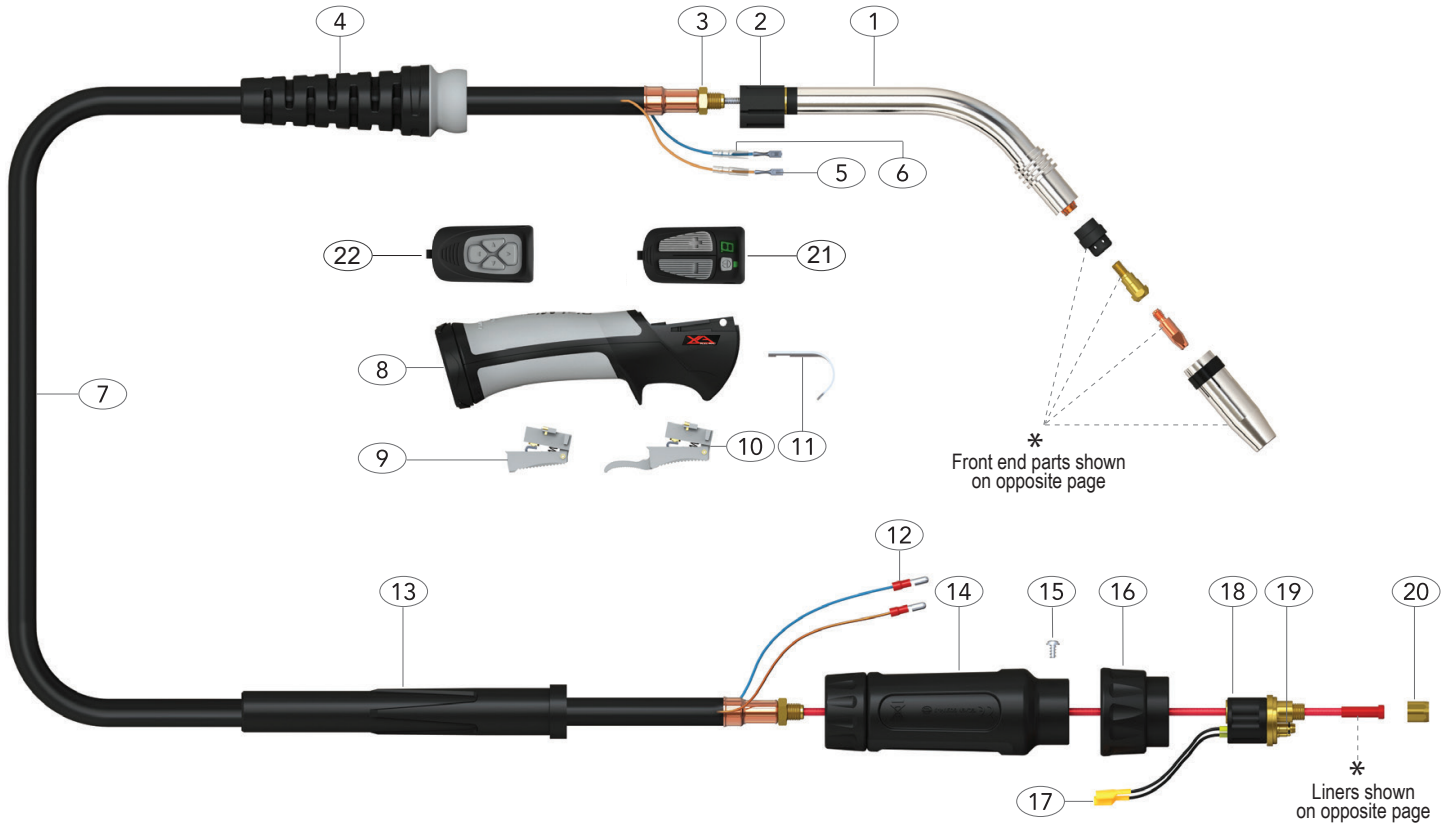

Torch Model		
Description	Part Number	
	3 Mt	4 Mt
DM24 Digital Torch Package	DM2400-JDM2-MT1-30ER	DM2400-JDM2-MT1-40ER

Spare Parts		
Part Number	Description	
1	XA2401	Torch neck XA24
2	XA1515/ER	Ergo Handle Location Body
3	XA1505	Lock Nut
4	XA8015	Cable Support
5	XA1521	Cable Terminal
6	XA1521-C	Cable Terminal Cover
7	XA2603-03	Duraflex Cable Assembly x 3m
	XA2603-04	Duraflex Cable Assembly x 4m
	XA2603-05	Duraflex Cable Assembly x 5m
8	XA2514/KJ	Digi-Mig Handle Kit
9	XA2516	Medium /Large Ergo Trigger
10	DM2516L	Extended Trigger Assembly
11	XA2517	Hanger Hook
12	XA1522	Cable Terminal - Male
13	XAA2041	Cable Support
14	XA1518	Gun Plug Housing c/w Nut
15	XA1541	Gun Plug Screw

Spare Parts		
Part Number	Description	
16	XA1519/S	Gun Plug Nut
17	XA1523	Gun Plug Terminal Female
18	XA1528	Gun Plug Body c/w Spring Pins
19	XA1524	Gun Plug O-Ring
20	XA1525	Liner Nut
21	DM2	Digi-Mig Control Module
22	MM2	Logic Control Module - Pulse Mig

MIG WELDING TORCHES

DM24 DIGITAL MIG TORCH



DM24 MIG TORCH CONSUMABLES

Suregrip™ Series

Front end consumables

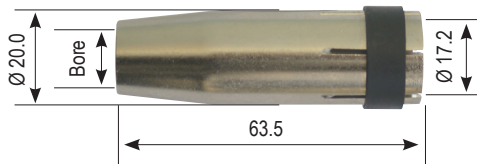
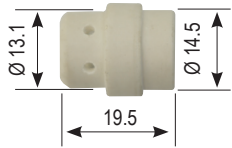
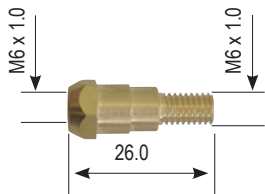
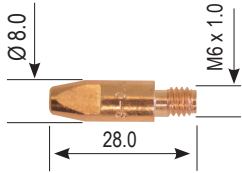

XA24 Contact Tips

Part Number	Description
XA2504-06	Contact Tip ECu 0.6mm D6 M6 x 28mm
XA2504-08	Contact Tip ECu 0.8mm D8 M6 x 28mm
XA2504-09	Contact Tip ECu 0.9mm D8 M6 x 28mm
XA2504-10	Contact Tip ECu 1.0mm D8 M6 x 28mm
XA2504-12	Contact Tip ECu 1.2mm D8 M6 x 28mm
XA2504-16	Contact Tip ECu 1.6mm D8 M6 x 28mm
XA2504-10A	Contact Tip ECu 1.0Amm D8 M6 x 28mm (for Aluminium)
XA2504-12A	Contact Tip ECu 1.2Amm D8 M6 x 28mm (for Aluminium)
XA2504-16A	Contact Tip ECu 1.6Amm D8 M6 x 28mm (for Aluminium)

Tip Holder XA24

Part Number	Description	Tip Thread	Material
XA2412	XA24 Tip Holder L = 26.0mm	M6	Brass

XA24 Diffuser

Part Number	Description	Colour	Material
XA2405W	XA24 Gas Diffuser L = 19.5mm	White	DMC3
XA2405C	XA24 Gas Diffuser L = 19.5mm	White	Ceramic
XA2405B	XA24 Gas Diffuser L = 19.5mm	Black	DMC3
XA2405S	XA24 Gas Diffuser L = 19.5mm	Red	Silicon

XA24 Gas Nozzle

Part Number	Description	Type	Bore Ø	Material
XA2415	XA24 Gas Nozzle	Cylindrical	17.2mm	Copper
XA2416	XA24 Gas Nozzle	Conical	12.5mm	Copper
XA2417	XA24 Gas Nozzle	Tapered	10.0mm	Copper

Liners



XA24 Liners

Part Number	Description
XA1535-30B	Insulated Liner 0.6-0.9mm wire x 3.4m (Blue)
XA1535-40B	Insulated Liner 0.6-0.9mm wire x 4.4m (Blue)
XA1535-50B	Insulated Liner 0.6-0.9mm wire x 5.4m (Blue)
XA2524-30B	Insulated Liner 0.9-1.2mm wire x 3.4m (Red)
XA2524-40B	Insulated Liner 0.9-1.2mm wire x 4.4m (Red)
XA2524-50B	Insulated Liner 0.9-1.2mm wire x 5.4m (Red)
XA2513-30B	Teflon Liner 1.0-1.2mm x 3.4m for Soft wire (Red)
XA2513-40B	Teflon Liner 1.0-1.2mm x 4.4m for Soft wire (Red)
XA2513-50B	Teflon Liner 1.0-1.2mm x 5.4m for Soft wire (Red)
XA2564-30	PA Liner 1.0-1.2mm x 3.4m for Soft & S/Steel wire, O.D = 4.0mm
XA2564-40	PA Liner 1.0-1.2mm x 4.4m for Soft & S/Steel wire, O.D = 4.0mm
XA3564-30	PA Liner 1.0-1.2mm x 3.4m for Soft & S/Steel wire, O.D = 4.7mm
XA3564-40	PA Liner 1.0-1.2mm x 4.4m for Soft & S/Steel wire, O.D = 4.7mm