

DIGITAL MIG WELDING TORCHES

DM26 DIGITAL MIG TORCH



DM26 MIG TORCH

Suregrip™ Series

290A AIR COOLED MIG WELDING TORCH

Rating: 290A CO₂ 250A mixed gas EN60974-7 @ 60% duty cycle. 0.8 to 1.2mm wires

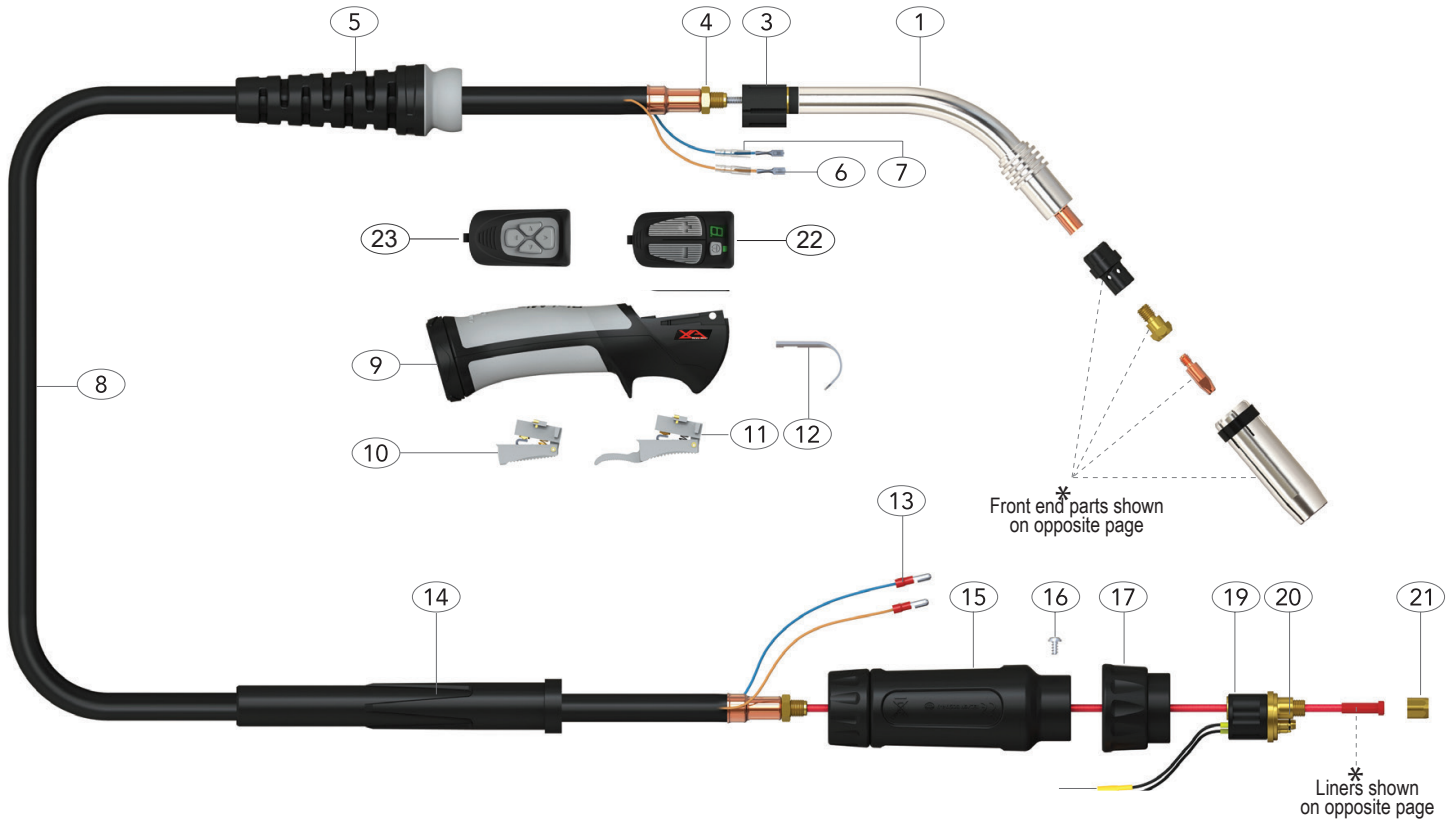

Torch Model	Description	
	Part Number	
	3 Mt	4 Mt
DM26 Digital Torch Package- MIG	DM2600-JDM2-MT1-30ER	DM2600-JDM2-MT1-40ER
DM26 Digital Torch Package- PULSE	DM2600-JMM2-MT2-30ER	DM2600-JMM2-MT2-40ER

Spare Parts		
Part Number	Description	
1	XA2601	Torch neck XA26
2	XA1515/ER	Ergo Handle Location Body
3	XA1505	Lock Nut
4	XA8015	Cable Support
5	XA1521	Cable Terminal
6	XA1521-C	Cable Terminal Cover
7	XA2603-03	Duraflex Cable Assembly x 3m
	XA2603-04	Duraflex Cable Assembly x 4m
	XA2603-05	Duraflex Cable Assembly x 5m
8	XA2514/KJ	Digi-Mig Handle Kit
9	XA2516	Medium /Large Ergo Trigger
10	DM2516L	Extended Trigger Assembly
11	XA2517	Hanger Hook
12	XA1522	Cable Terminal - Male
13	XAA2041	Cable Support
14	XA1518	Gun Plug Housing c/w Nut
15	XA1541	Gun Plug Screw

Spare Parts		
Part Number	Description	
16	XA1519/S	Gun Plug Nut
17	XA1523	Gun Plug Terminal Female
18	XA1528	Gun Plug Body c/w Spring Pins
19	XA1524	Gun Plug O-Ring
20	XA1525	Liner Nut
21	DM2	Digi-Mig Control Module
22	MM2	Logic Control Module - Pulse Mig

DM26 MIG TORCH CONSUMABLES

Suregrip™ Series

Front end consumables

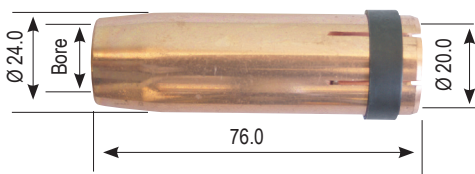
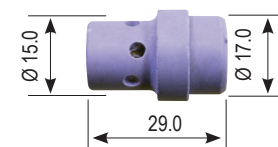
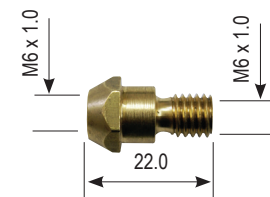
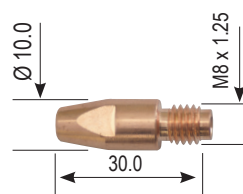
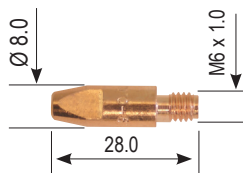

Liners



XA26 Contact Tips

Part Number	Description
XA2504-06	Contact Tip ECu 0.6mm D6 M6 x 28mm
XA2504-08	Contact Tip ECu 0.8mm D8 M6 x 28mm
XA2504-09	Contact Tip ECu 0.9mm D8 M6 x 28mm
XA2504-10	Contact Tip ECu 1.0mm D8 M6 x 28mm
XA2504-12	Contact Tip ECu 1.2mm D8 M6 x 28mm
XA2504-16	Contact Tip ECu 1.6mm D8 M6 x 28mm
XA2504-10A	Contact Tip ECu 1.0Amm D8 M6 x 28mm (for Aluminium)
XA2504-12A	Contact Tip ECu 1.2Amm D8 M6 x 28mm (for Aluminium)
XA2504-16A	Contact Tip ECu 1.6Amm D8 M6 x 28mm (for Aluminium)

XA26 Contact Tips M8

Part Number	Description
XA4014-08	Contact Tip ECu 0.8mm D10 M8 x 30mm
XA4014-09	Contact Tip ECu 0.9mm D10 M8 x 30mm
XA4014-10	Contact Tip ECu 1.0mm D10 M8 x 30mm
XA4014-12	Contact Tip ECu 1.2mm D10 M8 x 30mm
XA4014-16	Contact Tip ECu 1.6mm D10 M8 x 30mm
XA4014-10A	Contact Tip ECu 1.0Amm D10 M8 x 30mm (for Aluminium)
XA4014-12A	Contact Tip ECu 1.0Amm D10 M8 x 30mm (for Aluminium)
XA4014-16A	Contact Tip ECu 1.2Amm D10 M8 x 30mm (for Aluminium)

XA26 Tip Holder

Part Number	Description
XA2612	XA26 Tip Holder M6
XA2614	XA26 Tip Holder M8

XA26 Gas Diffuser

Part Number	Description
XA2605W	XA26 Gas Diffuser - White
XA2605C	XA26 Gas Diffuser - Ceramic

XA26 Gas Nozzle

Part Number	Description
XA5027	XA26/401W/501W Gas Nozzle - Cylindrical -19mm I.D
XA5028	XA26/401W/501W Gas Nozzle - Conical -16mm I.D
XA5029	XA26/401W/501W Gas Nozzle - Tapered-14mm I.D

XA26 Liners

Part Number	Description
XA1535-30B	Insulated Liner 0.6-0.9mm wire x 3.4m (Blue)
XA1535-40B	Insulated Liner 0.6-0.9mm wire x 4.4m (Blue)
XA1535-50B	Insulated Liner 0.6-0.9mm wire x 5.4m (Blue)
XA2524-30B	Insulated Liner 0.9-1.2mm wire x 3.4m (Red)
XA2524-40B	Insulated Liner 0.9-1.2mm wire x 4.4m (Red)
XA2524-50B	Insulated Liner 0.9-1.2mm wire x 5.4m (Red)
XA2513-30B	Teflon Liner 1.0-1.2mm x 3.4m for Soft wire (Red)
XA2513-40B	Teflon Liner 1.0-1.2mm x 4.4m for Soft wire (Red)
XA2513-50B	Teflon Liner 1.0-1.2mm x 5.4m for Soft wire (Red)
XA2564-30	PA Liner 1.0-1.2mm x 3.4m for Soft & S/Steel wire, O.D = 4.0mm
XA2564-40	PA Liner 1.0-1.2mm x 4.4m for Soft & S/Steel wire, O.D = 4.0mm
XA3564-30	PA Liner 1.0-1.2mm x 3.4m for Soft & S/Steel wire, O.D = 4.7mm
XA3564-40	PA Liner 1.0-1.2mm x 4.4m for Soft & S/Steel wire, O.D = 4.7mm