

MIG WELDING TORCHES

XA501W MIG TORCH



XA501W MIG TORCH

Suregrip™ Series

500A WATER COOLED MIG WELDING TORCH

Rating: 500A CO₂ 450A mixed gas EN60974-7 @ 60% duty cycle. 0.8 to 1.6mm wires

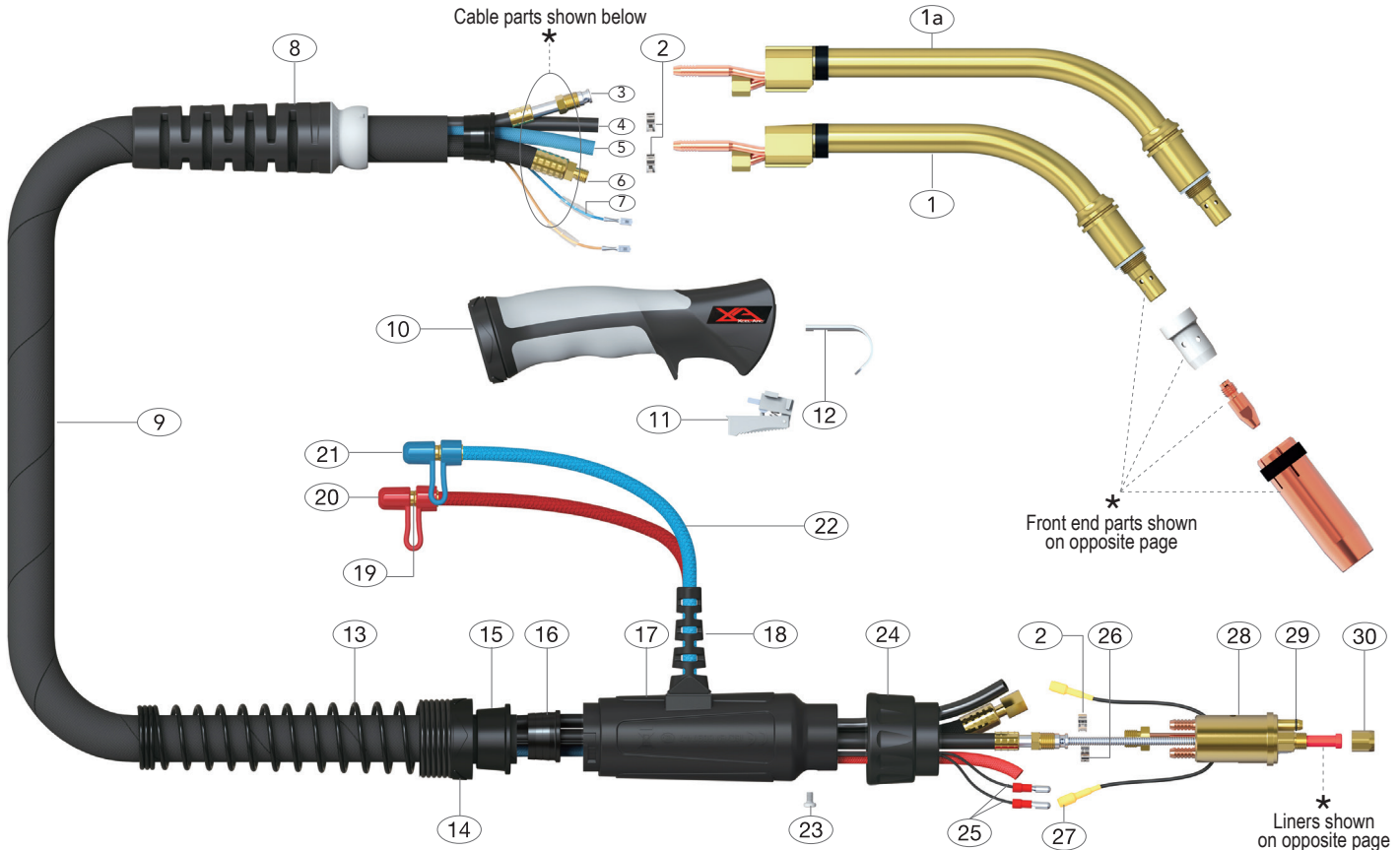

Torch Model	Description			
	Part Number	3 Mt	4 Mt	5 Mt
XA501W Suregrip Ergo Torch Package	XA501W-3		XA501W-4	XA501W-5

Spare Parts		
Part Number	Description	
1	XA5002	Swan Neck Assembly
1a	XA5002L	Swan Neck Assembly Long
2	XA5041	Water Hose Clamp 8.7mm
8	XA3208	Cable Support C/W Ball Joint
9	XA5019-30	Canvas Cover Assembly x 3m
	XA5019-40	Canvas Cover Assembly x 4m
	XA5019-50	Canvas Cover Assembly x 5m
10	XA2514	Ergo Handle Kit C/W Lock Nut
11	XA2516	Medium / Large Ergo Trigger
12	XA2517	Hanger Hook (optional extra)
13	XA8027	Housing Spring
14	XA8028	Spring Cable Support Nut
15	XA8009	Canvas Cover Clamp
16	XA8010	Canvas Cover Retainer Small
17	XA5022	Gun Plug Housing Assembly
18	XA1820-S	Inlet/Outlet Hose Support
19	XA5023	Water Hose Nipple
20	XA1522	Cable Terminal Male
20	XA80320	Red Cap Stopper
21	XA80310	Blue Cap Stopper

Spare Parts		
Part Number	Description	
22	XA5017	Water Outlet Hose O/Briard
23	XA1526	Gun Plug Screw
24	XA1519/S	Gun Plug Nut
25	XA1522	Gun Plug Terminal Male
26	XA5024	Water Hose Clamp 9.5mm
27	XA1523	Gun Plug Terminal Female
28	XA5098	Gun Plug Body C/W Spring Pins
29	XA1524	Gun Plug 'O' Ring
30	XA1525	Liner Nut

Cable parts				
Description	Part Number			
	3m	4m	5m	
3	Outer Liner	XA5008-30	XA5008-40	XA5008-50
4	Gas Hose	XA5013-30	XA5013-40	XA5013-50
5	Water Inlet Hose	XA5012-30	XA5012-40	XA5012-50
6	Power Cable	XA5015-30	XA5015-40	XA5015-50
7	Switch Lead	XA5010-30	XA5010-40	XA5010-50

XA501W MIG TORCH CONSUMABLES

Suregrip™ Series

Front end consumables

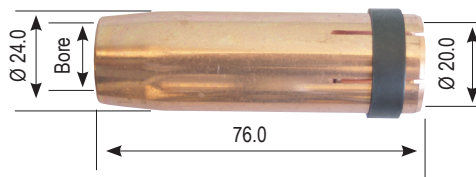
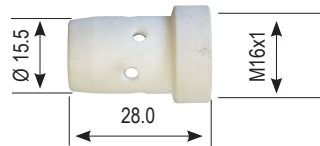
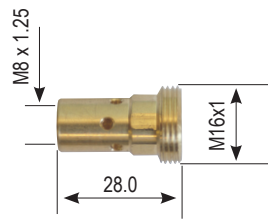
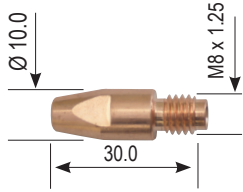

XA501W Contact Tips M8

Part Number	Description
XA4014-08	Contact Tip ECu 0.8mm D10 M8 x 30mm
XA4014-09	Contact Tip ECu 0.9mm D10 M8 x 30mm
XA4014-10	Contact Tip ECu 1.0mm D10 M8 x 30mm
XA4014-12	Contact Tip ECu 1.2mm D10 M8 x 30mm
XA4014-16	Contact Tip ECu 1.6mm D10 M8 x 30mm
XA4014-20	Contact Tip ECu 2.0mm D10 M8 x 30mm
XA4014-10A	Contact Tip ECu 1.0Amm D10 M8 x 30mm (for Aluminium)
XA4014-12A	Contact Tip ECu 1.2Amm D10 M8 x 30mm (for Aluminium)
XA4014-16A	Contact Tip ECu 1.6Amm D10 M8 x 30mm (for Aluminium)

XA501W Tip Holders

Part Number	Description	Tip Thread	Material
XA5001	XA401/501W Tip Holder 25.0mm	M8	Brass
XA5001C	XA401/501W Tip Holder 25.0mm	M8	CuCrZr

XA501W Gas Diffusers

Part Number	Description	Colour	Material
XA5005W	XA38 / 401W / 501W Threaded Diffuser	White	DMC3
XA5005C	XA38 / 401W / 501W Threaded Diffuser	White	Ceramic
XA5005H	XA38 / 401W / 501W Threaded Diffuser	Black	HPP

XA401W Insulating Washer

Part Number	Description	Material
XA5003	XA38/401W/501W Insulating Washer	Fibre

XA501W Gas Nozzle

Part Number	Description
XA5027	XA26/401W/501W Gas Nozzle - Cylindrical -19mm I.D
XA5028	XA26/401W/501W Gas Nozzle - Conical -16mm I.D
XA5029	XA26/401W/501W Gas Nozzle - Tapered-14mm I.D

XA501W Liners

Part Number	Description
XA2524-30B	Insulated Liner 0.9-1.2mm wire x 3.4m (Red)
XA2524-40B	Insulated Liner 0.9-1.2mm wire x 4.4m (Red)
XA2524-50B	Insulated Liner 0.9-1.2mm wire x 5.4m (Red)
XA3631-30B	Insulated Liner 1.6mm wire x 3.4m (Yellow)
XA3631-40B	Insulated Liner 1.6mm wire x 4.4m (Yellow)
XA3631-50B	Insulated Liner 1.6mm wire x 5.4m (Yellow)
XA2513-30B	Teflon Liner 1.0-1.2mm x 3.4m for Soft wire
XA2513-40B	Teflon Liner 1.0-1.2mm x 4.4m for Soft wire
XA2513-50B	Teflon Liner 1.0-1.2mm x 5.4m for Soft wire
XA2564-30	PA Liner 1.0-1.2mm x 3.4m for Soft & S/Steel wire, O.D = 4.0mm
XA2564-40	PA Liner 1.0-1.2mm x 4.4m for Soft & S/Steel wire, O.D = 4.0mm
XA3564-30	PA Liner 1.0-1.2mm x 3.4m for Soft & S/Steel wire, O.D = 4.7mm
XA3564-40	PA Liner 1.0-1.2mm x 4.4m for Soft & S/Steel wire, O.D = 4.7mm

Liners

