

MIG WELDING TORCHES

XAP401W PUSH-PULL TORCH



400A WATER COOLED MIG WELDING TORCH

Rating: 400A CO₂ 350A mixed gas EN60974-7 @ 100% duty cycle. 1.0 to 1.6mm wires

Suregrip™ Series

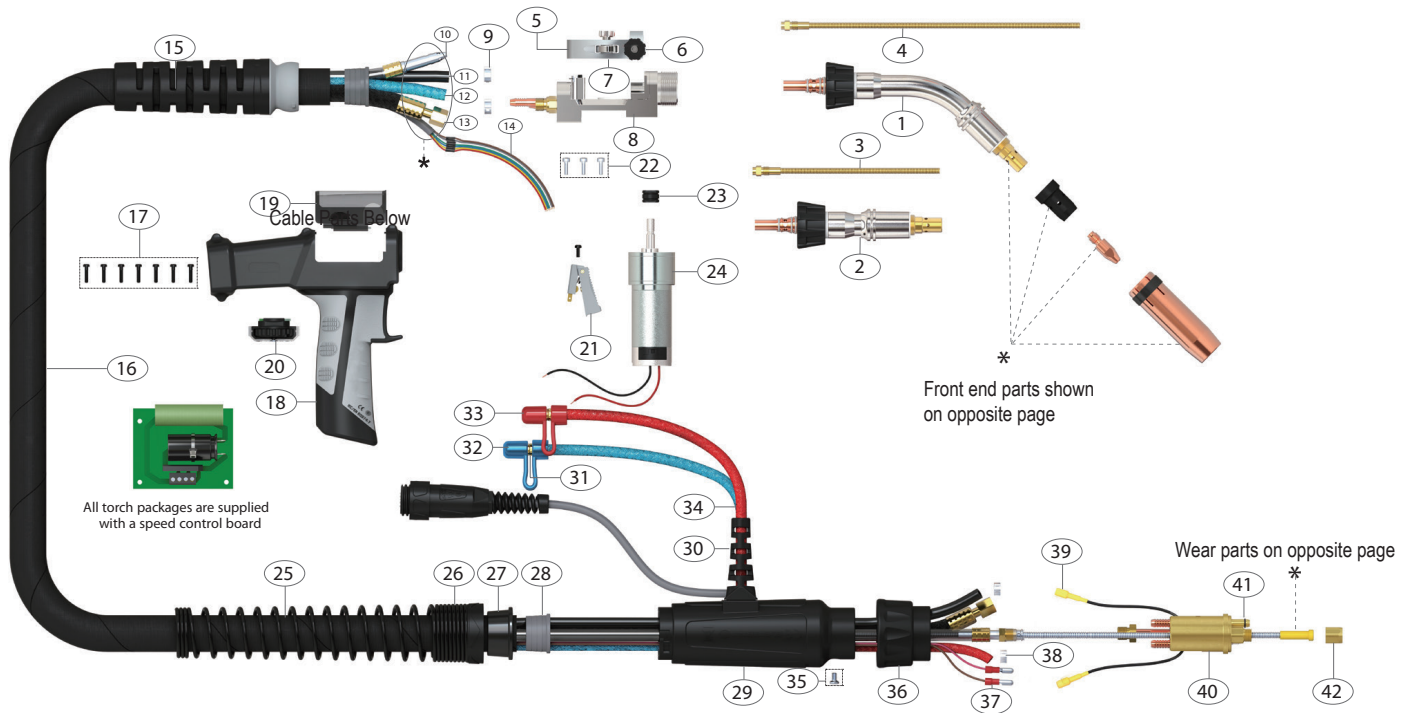

Torch Model	Part Number
-------------	-------------

XAP401W Suregrip™ 24v Push Pull Mig Torch Package 45° Neck x 8m	XAP4001-24-W45-80ER
XAP401W Suregrip™ 24v Push Pull Mig Torch Package Straight Neck x 8m	XAP4001-24-W180-80ER
XAP401W Suregrip™ 42v Push Pull Mig Torch Package 45° Neck x 8m	XAP4001-42-W45-80ER
XAP401W Suregrip™ 42v Push Pull Mig Torch Package Straight Neck x 8m	XAP4001-42-W180-80ER

Spare Parts		
Part Number	Description	

1	XAP4011	Swan Neck Assembly 45O
2	XAP4011A	Straight Neck Assembly
3	XAP4002	Jump Liner C/W Nipple
4	XAP4002A	Jump Liner C/W Nipple
5	XAP36402	Pressure Arm Assembly
6	XAP36402B	Tension Knob
7	XAP36402R	Pressure Roll
8	XAP40101	Motor Body
9	XA5041	Water Hose Clamp 8.7MM
15	XA3208	Handle Cable Support
16	XAP36419-80	Canvas Cover Assembly
17	XASP1	Handle Screw Pack
18	XAP2514/KJ	Push Pull Handle
19	XAP2514/C	Push Pull Handle Cover
20	XAP0807-5	Potentiometer Kit 5K
	XAP0807-10	Potentiometer Kit 10K
	XAP0807-25	Potentiometer Kit 25K
21	XAP2516	Trigger
22	XAPMS1	Motor Screw
23	XAP8224W-08	Drive Roll For Wire 0.8
	XAP8224W-09	Drive Roll For Wire 0.9
	XAP8224W-10	Drive Roll For Wire 1.0
	XAP8224W-12	Drive Roll For Wire 1.2
	XAP8224W-16	Drive Roll For Wire 1.6
	XAP8224W-09U	Drive Roll U Groove 0.9mm
	XAP8224W-10U	Drive Roll U Groove 1.0mm
	XAP8224W-12U	Drive Roll U Groove 1.2mm

Spare Parts		
Part Number	Description	

24	XAP8224-24	Motor 24V DC
	XAP8224-42	Motor 42V DC
25	XA8027	Housing Spring
26	XA8028	Spring Cable Support Nut
27	XA8009	Canvas Cover Clamp
28	XA8010	Canvas Cover Retainer
29	UT5022	Gun Plug Housing Assembly
30	USLH1820-S	Inlet/Outlet Hose Support
31	UB5023	Water Hose Nipple
32	UBD-80310	Blue Cap Stopper
33	UBD-80320	Red Cap Stopper
34	US5017	Water Outlet Hose O/braid Rubber
35	XA1526	Gun Plug Screw
36	XA1519/S	Gun Plug Nut
37	XA1522	Cable Terminal Male
38	XA5024	Water Hose Clamp 9.5MM
39	XA1523	Gun Plug Terminal Female
40	UB5098	Gun Plug Body C/W Spring Pins
41	XA1524	Gun Plug 'O' Ring
42	XA1525	Liner Nut

Cable Parts		
Part Number	Description	

10	XAP36408-80	Outer Liner Assembly
11	XAP36413-80	Gas Hose Assembly
12	XAP40112-80	Water Inlet Hose Assembly
13	XAP40115-80	Power Cable Assembly
14	XAP36410-80	Switch Lead Assembly

MIG WELDING TORCHES

XAP401W PUSH-PULL TORCH



XAP410W MIG TORCH CONSUMABLES

Suregrip™ Series

Front end consumables

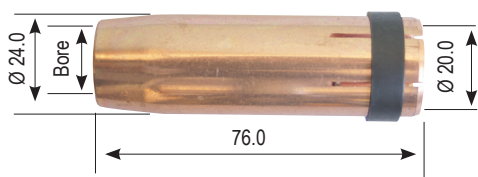
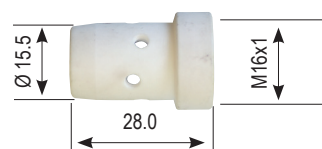
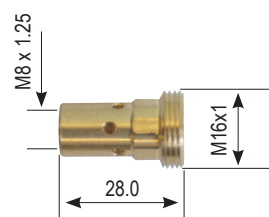
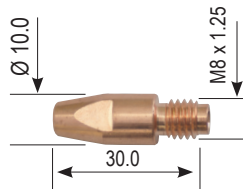

XA401W Contact Tips M8

Part Number	Description
XA4014-08	Contact Tip ECu 0.8mm D10 M8 x 30mm
XA4014-09	Contact Tip ECu 0.9mm D10 M8 x 30mm
XA4014-10	Contact Tip ECu 1.0mm D10 M8 x 30mm
XA4014-12	Contact Tip ECu 1.2mm D10 M8 x 30mm
XA4014-16	Contact Tip ECu 1.6mm D10 M8 x 30mm
XA4014-20	Contact Tip ECu 2.0mm D10 M8 x 30mm
XA4014-10A	Contact Tip ECu 1.0Amm D10 M8 x 30mm (for Aluminium)
XA4014-12A	Contact Tip ECu 1.2Amm D10 M8 x 30mm (for Aluminium)
XA4014-16A	Contact Tip ECu 1.6Amm D10 M8 x 30mm (for Aluminium)

XA401W Tip Holders

Part Number	Description	Tip Thread	Material
XA5001	XA401/501W Tip Holder 25.0mm	M8	Brass
XA5001C	XA401/501W Tip Holder 25.0mm	M8	CuCrZr

XA401W Gas Diffusers

Part Number	Description	Colour	Material
XA5005W	XA401W / 501W Diffuser	White	DMC3
XA5005C	XA401W / 501W Diffuser	White	Ceramic
XA5005B	XA401W / 501W Diffuser	Black	DCM3
XA5005H	XA401W / 501W Diffuser	Black	HPP

XA401W Insulating Washer

Part Number	Description	Material
XA5003	XA38/401W/501W Insulating Washer	Fibre

XA401W Gas Nozzle

Part Number	Description
XA5027	XA26/401W/501W Gas Nozzle - Cylindrical -19mm I.D
XA5028	XA26/401W/501W Gas Nozzle - Conical -16mm I.D
XA5029	XA26/401W/501W Gas Nozzle - Tapered-14mm I.D

Liners



XAP360 Liners

Part Number	Description
XA5033-80B	Steel Liner 0.8-1.2mm wire x 8.5m Brass Nipple
XA5034-80B	Steel Liner 1.2-1.6mm wire x 8.5m Brass Nipple
XA2513-80	Teflon Liner 0.8-1.2mm wire x 8.6m Brass Nipple
XA3564-80	PA Liner 1.0-1.6mm wire x 8.5m Brass Nipple