

# DIGITAL MIG WELDING TORCHES

## DM36 DIGITAL MIG TORCH



# DM36 MIG TORCH

**Suregrip™ Series**

### 320A AIR COOLED MIG WELDING TORCH

Rating: 320A CO<sub>2</sub> 290A mixed gas EN60974-7 @ 60% duty cycle. 0.8 to 1.2mm wires

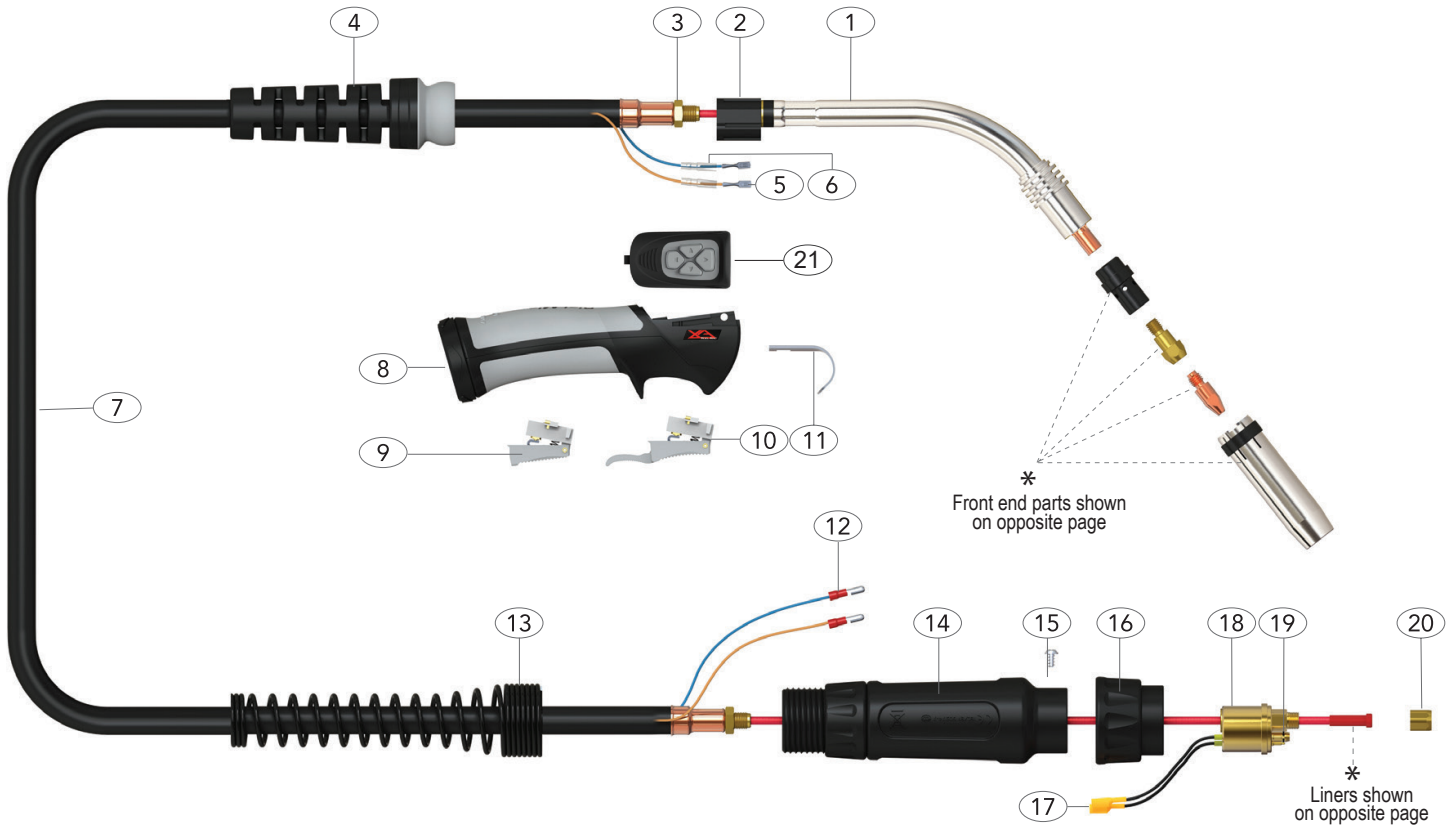

#### Torch Model

Description	Part Number 3 Mt	4 Mt	5 Mt
DM36 Digital Torch Package- PULSE	DM3600-NMM2-MT1-30ER	DM3600-NMM2-MT1-40ER	DM3600-NMM2-MT1-50ER

#### Spare Parts

Part Number	Description
1	XA3603 Torch neck XA36
2	XA1515 Ergo Handle Location Body
3	XA1505 Lock Nut
4	XA8016 Cable Support
5	XA1521 Cable Terminal
6	XA1521-C Cable Terminal Cover
7	XA3609-03 Duraflex Cable Assembly x 3m
	XA3609-04 Duraflex Cable Assembly x 4m
	XA3609-05 Duraflex Cable Assembly x 5m
8	XA2514/KJ Digi-Mig Handle Kit
9	XA2516 Medium /Large Trigger
10	XA2517 Hanger Hook
11	XA1522 Cable Terminal - Male
12	XA8026 Spring Cable Support
13	XA8028 Cable Support Nut
14	XA1518L Gun Plug Housing c/w Nut

#### Spare Parts

Part Number	Description
15	XA1526 Gun Plug Screw
16	XA1519/S Gun Plug Nut c/w Insert
17	XA1523 Gun Plug Terminal
18	XA1528 Gun Plug Body c/w Spring Pins
19	XA1524 Gun Plug O-Ring
20	XA1525 Liner Nut
21	MM2 Logic Control Module - Pulse Mig

### DM36 MIG TORCH CONSUMABLES

### Suregrip™ Series

#### Front end consumables

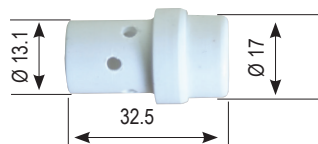
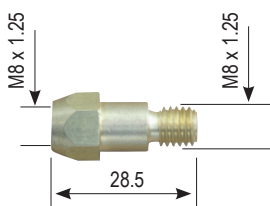
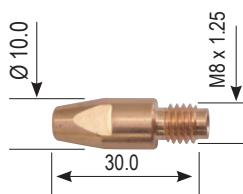
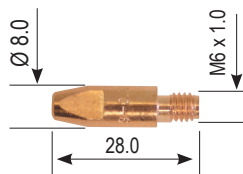

#### Liners



#### XA36 Contact Tips M6

Part Number	Description
XA2504-06	Contact Tip ECu 0.6mm D6 M6 x 28mm
XA2504-08	Contact Tip ECu 0.8mm D8 M6 x 28mm
XA2504-09	Contact Tip ECu 0.9mm D8 M6 x 28mm
XA2504-10	Contact Tip ECu 1.0mm D8 M6 x 28mm
XA2504-12	Contact Tip ECu 1.2mm D8 M6 x 28mm
XA2504-16	Contact Tip ECu 1.6mm D8 M6 x 28mm
XA2504-10A	Contact Tip ECu 1.0Amm D8 M6 x 28mm (for Aluminium)
XA2504-12A	Contact Tip ECu 1.2Amm D8 M6 x 28mm (for Aluminium)
XA2504-16A	Contact Tip ECu 1.6Amm D8 M6 x 28mm (for Aluminium)

#### XA36 Contact Tips M8

Part Number	Description
XA4014-08	Contact Tip ECu 0.8mm D10 M8 x 30mm
XA4014-09	Contact Tip ECu 0.9mm D10 M8 x 30mm
XA4014-10	Contact Tip ECu 1.0mm D10 M8 x 30mm
XA4014-12	Contact Tip ECu 1.2mm D10 M8 x 30mm
XA4014-16	Contact Tip ECu 1.6mm D10 M8 x 30mm
XA4014-20	Contact Tip ECu 2.0mm D10 M8 x 30mm
XA4014-10A	Contact Tip ECu 1.0Amm D10 M8 x 30mm (for Aluminium)
XA4014-12A	Contact Tip ECu 1.2Amm D10 M8 x 30mm (for Aluminium)
XA4014-16A	Contact Tip ECu 1.6Amm D10 M8 x 30mm (for Aluminium)

#### XA36 Tip Holder

Part Number	Description	Tip Thread	Material
XA3612	XA36 Tip Holder L = 28.5mm	M6	Brass
XA3614	XA36 Tip Holder L = 28.5mm	M8	Brass

#### Gas Diffuser XA36

Part Number	Description	Colour	Material
XA3605W	XA36 Gas Diffuser L = 32.5mm	White	DMC3
XA3605C	XA36 Gas Diffuser L = 32.5mm	White	Ceramic
XA3605B	XA36 Gas Diffuser L = 32.5mm	Black	DCM3
XA3605H	XA36 Gas Diffuser High Temp	Black	HPP

#### XA36 Gas Nozzle

Part Number	Description	Type	Bore Ø	Material
XA3615	XA36 Gas Nozzle	Cylindrical	19.0mm	Copper
XA3616	XA36 Gas Nozzle	Conical	16.0mm	Copper
XA3617	XA36 Gas Nozzle	Tapered	12.0mm	Copper

#### XA36 Liners

Part Number	Description
XA2524-30B	Insulated Liner 0.9-1.2mm wire x 3.4m (Red)
XA2524-40B	Insulated Liner 0.9-1.2mm wire x 4.4m (Red)
XA2524-50B	Insulated Liner 0.9-1.2mm wire x 5.4m (Red)
XA3631-30B	Insulated Liner 1.6mm wire x 3.4m (Yellow)
XA3631-40B	Insulated Liner 1.6mm wire x 4.4m (Yellow)
XA3631-50B	Insulated Liner 1.6mm wire x 5.4m (Yellow)
XA2513-30B	Teflon Liner 1.0-1.2mm x 3.4m for Soft wire
XA2513-40B	Teflon Liner 1.0-1.2mm x 4.4m for Soft wire
XA2513-50B	Teflon Liner 1.0-1.2mm x 5.4m for Soft wire
XA2564-30	PA Liner 1.0-1.2mm x 3.4m for Soft & S/Steel wire, O.D = 4.0mm
XA2564-40	PA Liner 1.0-1.2mm x 4.4m for Soft & S/Steel wire, O.D = 4.0mm
XA3564-30	PA Liner 1.0-1.2mm x 3.4m for Soft & S/Steel wire, O.D = 4.7mm
XA3564-40	PA Liner 1.0-1.2mm x 4.4m for Soft & S/Steel wire, O.D = 4.7mm